

4

3

2

1

B

B

A

A

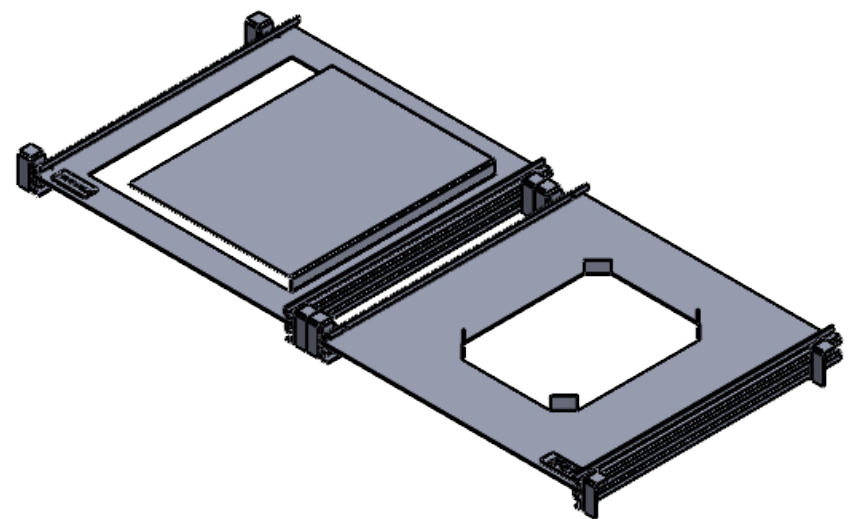
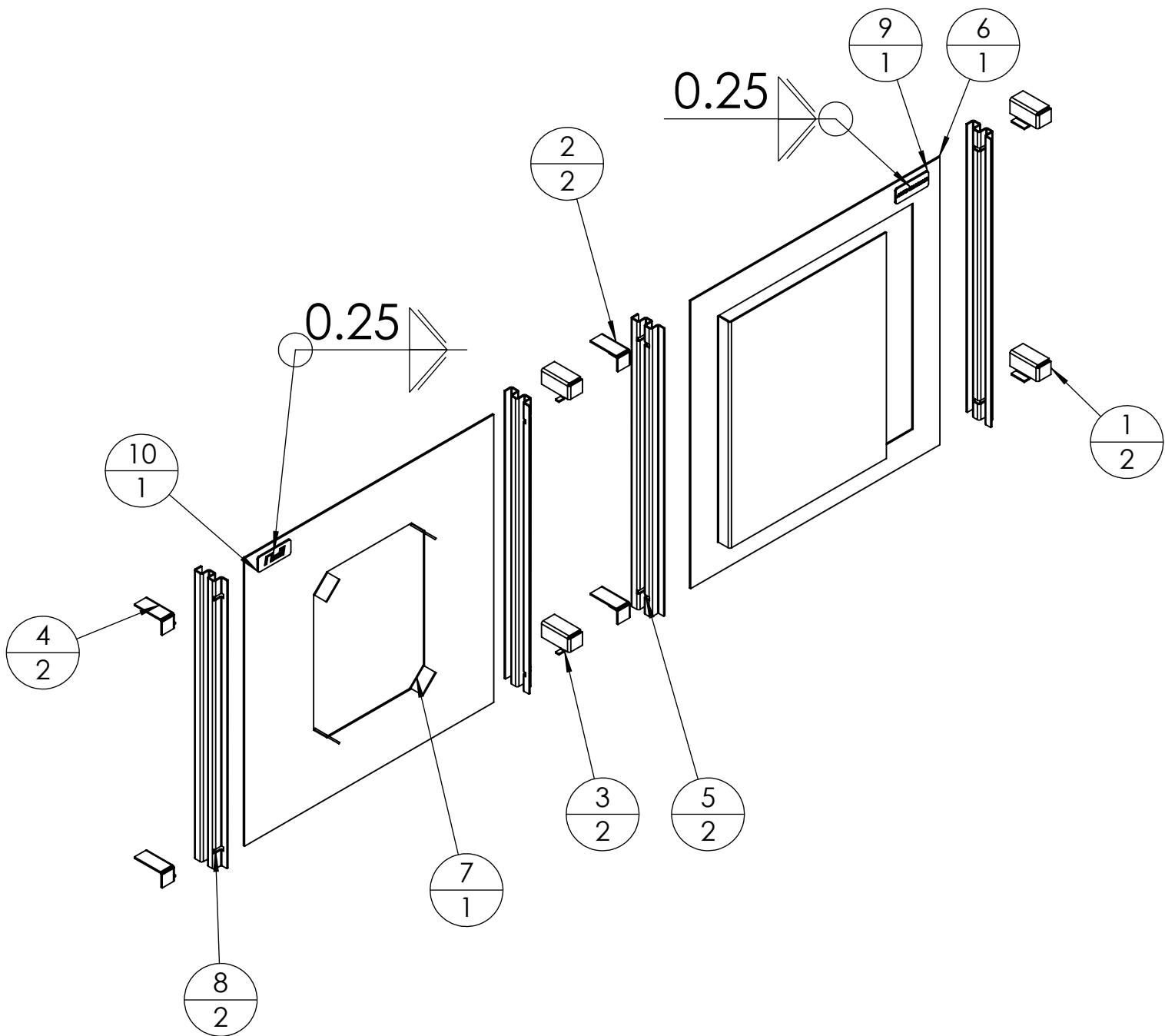

ITEM NO.	PART NUMBER	DESCRIPTION	QTY.
1	003-00007-001	MOUNT, LEFT, STATIONERY, FULL SERVER RACK	2
2	003-00008-001	MOUNT, RIGHT, STATIONERY, FULL SERVER RACK	2
3	003-00025-001	MOUNT, LEFT, IFU RACK, FULL SERVER RACK	2
4	003-00026-001	MOUNT, RIGHT, IFU RACK, FULL SERVER RACK	2
5	003-00076-001	SIDE BRACE, STATIONERY, FULL SERVER RACK	2
6	003-00040-001	SHELF, STATIONERY, FULL SERVER RACK	1
7	003-00049-001	SHELF, IFU RACK, FULL SERVER RACK	1
8	003-00085-001	SIDE BRACE, IFU RACK, FULL SERVER RACK	2
9	003-00058-001	NAMEPLATE, STATIONERY, FULL SERVER RACK	1
10	003-00067-001	NAMEPLATE, IFU RACK, FULL SERVER RACK	1

NOTES: UNLESS OTHERWISE SPECIFIED.
1. PARAMETRIC MODEL. ALL DIMENSIONS FURTHER SPECIFIED IN 003-00106.
2. ASSEMBLY SHALL NOT BE MODIFIED BY ANY PARTY OUTSIDE PAPERLESS PARTS, INC UNLESS WRITTEN OR EXPRESS APPROVAL HAS BEEN PERMITTED FOR THE ASSEMBLY.

	UNLESS OTHERWISE SPECIFIED:		NAME	DATE	<div><div>paperlessPARTS</div><div></div></div> <div>TITLE: FOURTH RACK, FULL SERVER RACK</div> <div><div>SIZE</div><div>B</div><div>DWG. NO.</div><div>003-00106</div><div>REV</div><div>000</div></div> <div><div>SCALE: NTS</div><div>WEIGHT: SEE MODEL</div><div>SHEET 1 OF 1</div></div>			
	DIMENSIONS ARE IN INCHES TOLERANCES: ANGULAR: MACH ± 1.0° BEND ± 0.5° ONE PLACE DECIMAL ± 0.1 TWO PLACE DECIMAL ± 0.05		DRAWN	NM				8/30/2024
			CHECKED					
			ENG APPR.					
			MFG APPR.					
<div>PROPRIETARY AND CONFIDENTIAL</div> <div>THE INFORMATION CONTAINED IN THIS DRAWING IS THE SOLE PROPERTY OF PAPERLESS PARTS, INC. ANY REPRODUCTION IN PART OR AS A WHOLE WITHOUT THE WRITTEN PERMISSION OF PAPERLESS PARTS, INC IS PROHIBITED.</div>	INTERPRET GEOMETRIC TOLERANCING PER: ASME Y14.5		Q.A.			<div></div>		
	MATERIAL		COMMENTS:					
	N/A							
	FINISH							
	N/A							
DO NOT SCALE DRAWING								